

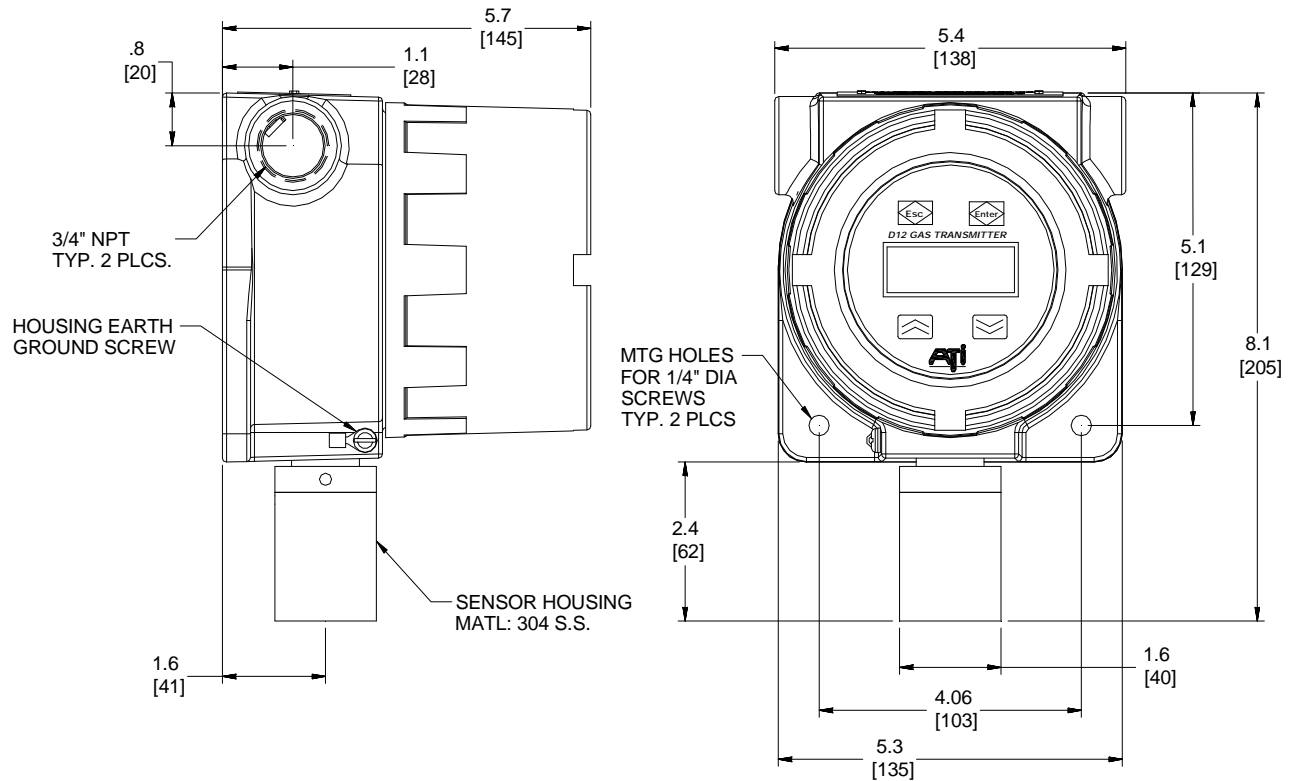

ENCLOSURE DIMENSIONS



NOTES:

- 1) **Enclosure Matl:** Sand Cast copper-free aluminum
O-Brien yellow in color.
Cover: Sand Cast copper-free aluminum O-Brien yellow in color,
with 3-5/16" dia. tempered glass window.

2) Certifications:

DEMKO 18 ATEX 2066X
CE 0539  II 2 G Ex db IIC T6 Gb
- EN 60079-0:2012+A11:2013
- EN 60079-1:2014

IECEX UL 18.0080X
Ex db IIC T6 Gb

- IEC 60079-0 (2011-06) + Corr.1 (2012-01) + Corr. 2(2013-12) + I-SH 01(2013-11) + I-SH 02 (2014-10)
- IEC 60079-1, 7th Edition (2014-06)

3) Ratings:

UL Class I, Groups B,C,D
Class II, Groups E,F,G
CENELAC: EExd IIC, IP66
Nema 4X, 78CD, 9EFG

ATI-1203

POWER SUPPLY PCB GENERAL LAYOUT

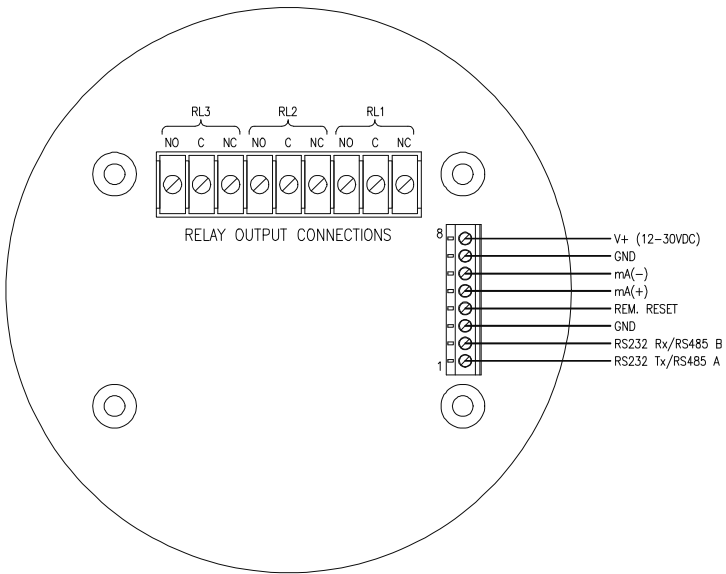

ATI-0526

3-WIRE WIRING DIAGRAM

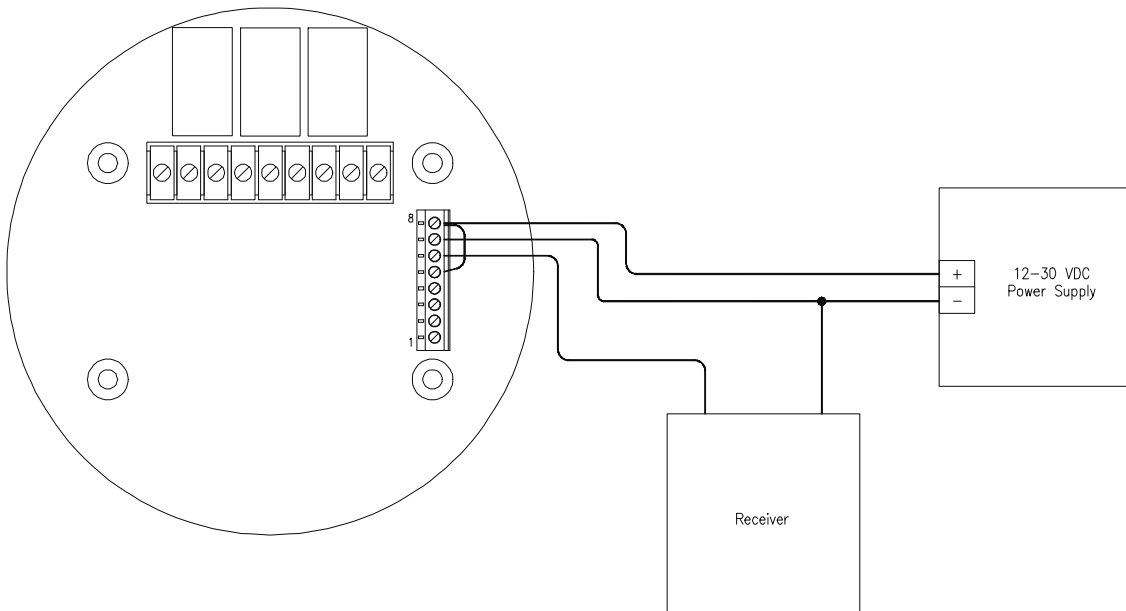

ATI-0528

REMOTE SENSOR DIMENSIONAL DRAWING

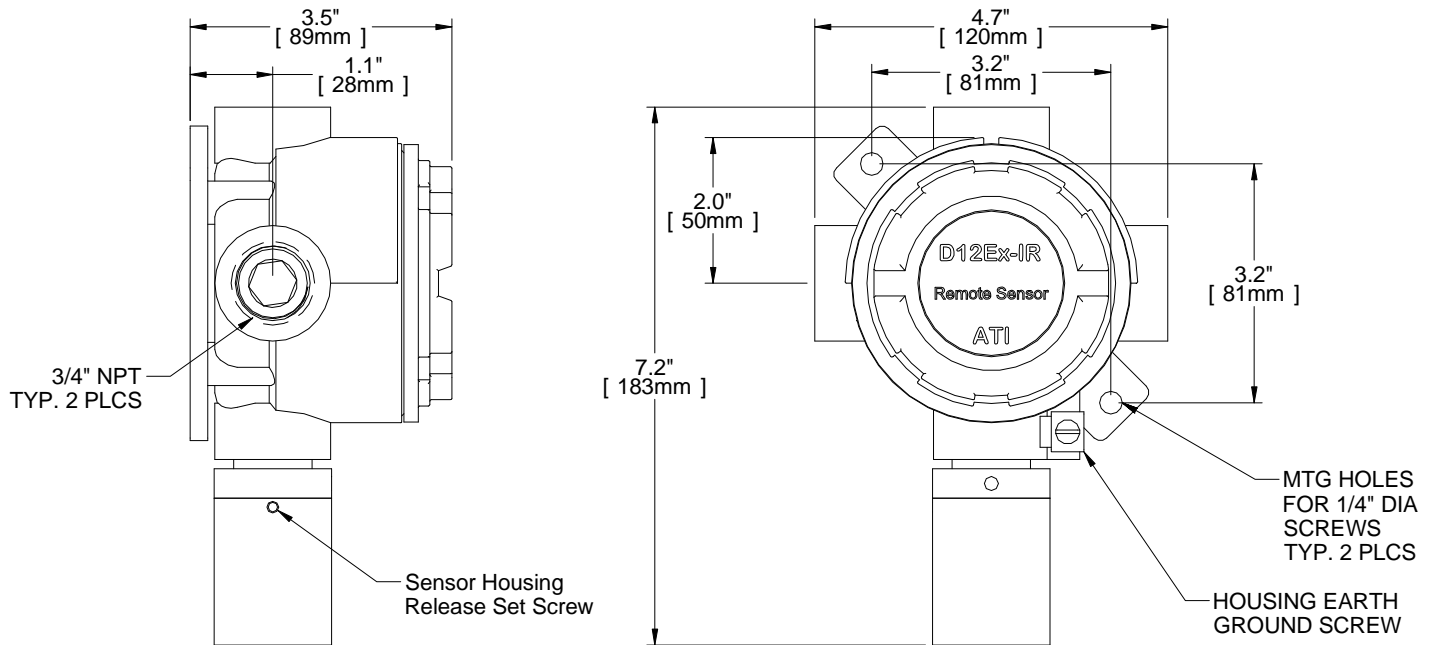

ENCLOSURE RATINGS:

CLASS I, GROUPS B,C,D
CLASS II, GROUPS E,F,G
CLASS III

Assembly is normally mounted directly to suitable explosion-proof conduit. To maintain the explosion-proof integrity of the transmitter, a suitable cable entry seal must be used in accordance with the applicable electrical code.

ATI-1204

REMOTE SENSOR WIRING DIAGRAMS

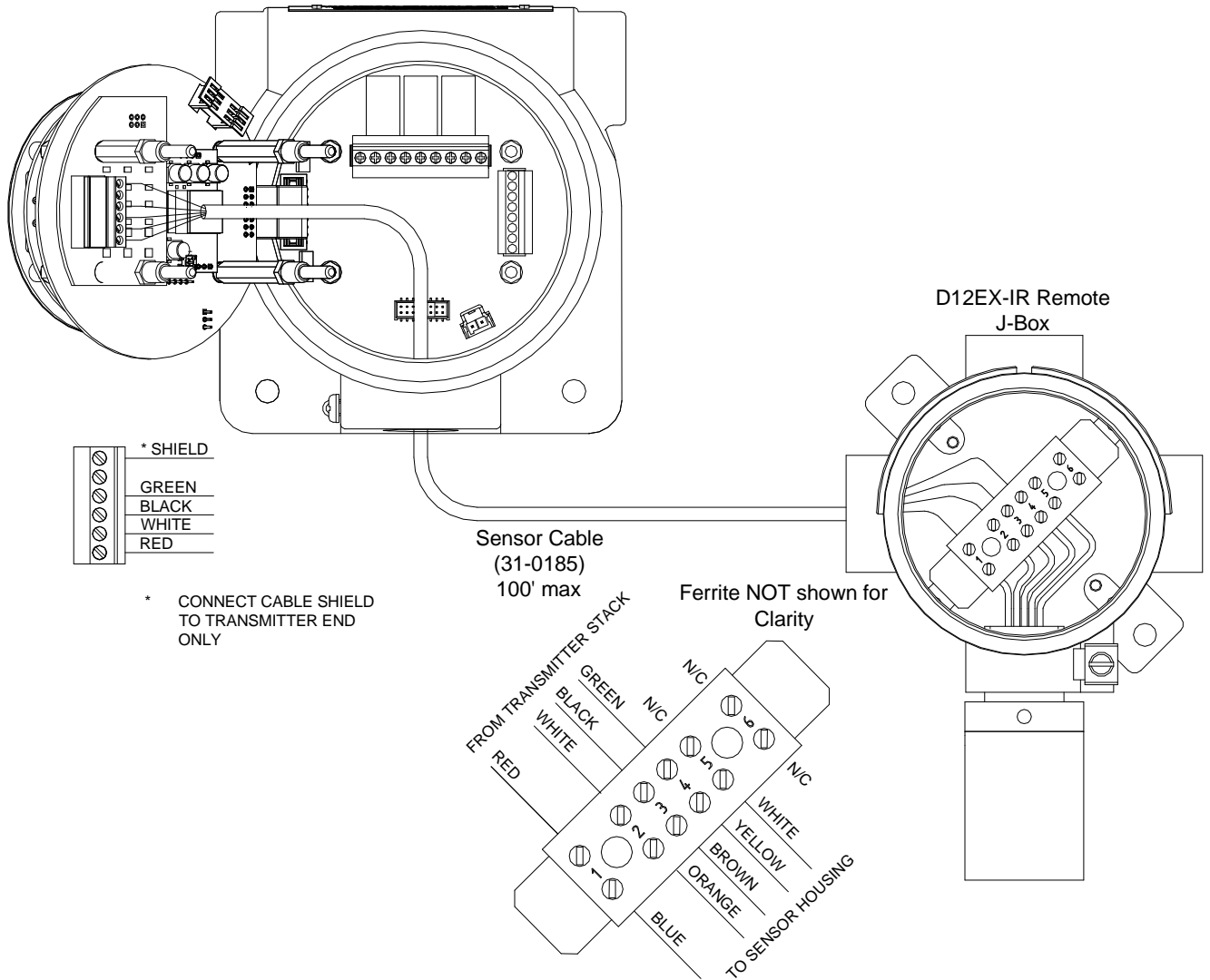

ATI-1205

FLOWCELL / CALIBRATION ADAPTER (60-0069)

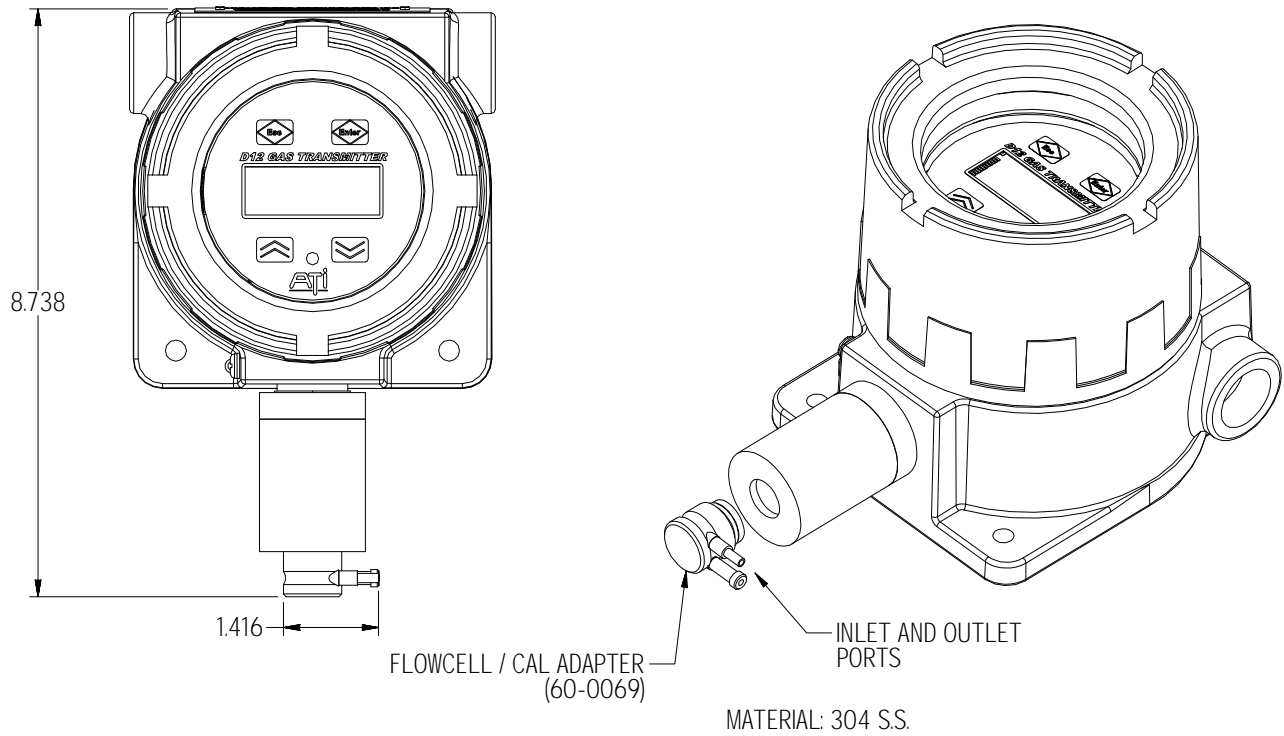

RAIN SHIELD (60-0068)

