

## MULTIPURPOSE CYLINDERS, OIL RETURN

### FEATURES

These cylinders have: collar thread, internal rod thread and base mounting holes.

They are supplied with interchangeable grooved saddle and models over 30 tonne have eyelets for transport.

A safety valve connected to the retract chamber avoids any overpressure.

The guide nut has a wiper ring to prevent the ingress of dirt and to extend the working life of the cylinder.

### OPERATIONAL AREAS

Highly versatile and heavy duty cylinders designed to be used in industrial applications with a high number of working cycles.

They are also used in pushing of underpass construction, in piling operations and because of their collar thread they can be used in presses.

p. 39

### ACCESSORIES



Separate **ZTT tilt saddle**, reduces the effects of possible off-centred loads.

### STANDARD



Base mounting **holes**.

**Pushing saddle**, prevents any risk of rod deformation.

p. 126

Follow our safety instructions.  
See useful pages.



p. 40



In case of occasional operation the cylinders of the COS range could be a more economical solution.



p. 67



The modular power packs with **4 way valves** are particularly suitable to operate these cylinders.

## MULTIPURPOSE CYLINDERS, OIL RETURN

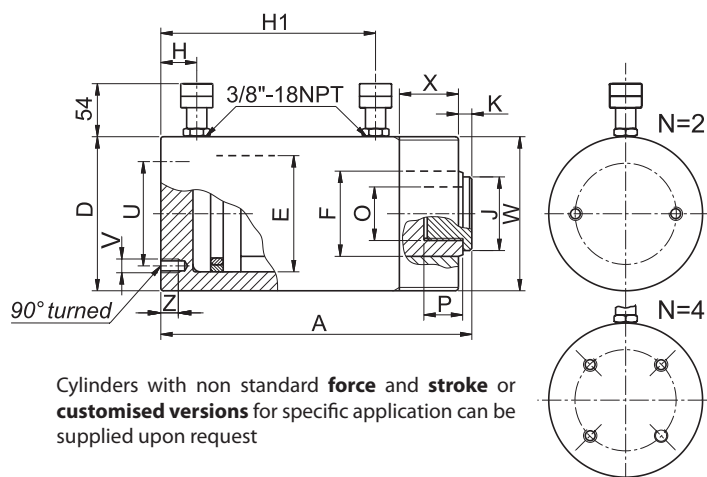

Cylinders with non standard **force** and **stroke** or **customised versions** for specific application can be supplied upon request



- Force **10 - 500 t**
- Stroke **150 - 325 mm**
- Max working pressure **700 bar**

### SELECTION CHART

Pushing force t* kN	Pulling force t* kN	Stroke mm	Pushing oil volume cm <sup>3</sup>	Pulling oil volume cm <sup>3</sup>	MODEL	Closed height A mm	External Dia. D mm	Piston Dia. E mm	Rod Dia. F mm	Coupler height		Saddle Dia. J mm	Rod projection K mm	Rod internal thread O mm	Rod thread depth P mm	PCD mounting holes U mm	Mounting holes_Depth V/Z mm	Collar thread_Tread length W/X mm	Weight kg
										H mm	H1 mm								
10 111	5 55	150	239	118	COI10N150	258	60	45	32	19	213	34	6	M24x2	15	39	2xM8 12	M60x1,5 20	5,2
		250	398	197	COI10N250	358				313	6,8								
30 309	10 111	150	663	239	COI30N150	279	100	75	60	23	221	53	9	M32x2	16	50	2xM10 15	M100x2 30	15,5
		250	1104	398	COI30N250	379				331	20,5								
50 496	15 144	150	1063	309	COI50N150	288	127	95	80	25	234	65	4	M16	17	75	2xM12 18	M125x2 31	26,5
		325	2304	670	COI50N325	463				409	41,0								
100 929	38 379	150	1991	813	COI100N150	323	175	130	100	33	250	85	4	M16	17	100	4xM12 23	M168x2 50	55
		300	3982	1626	COI100N300	473				400	77								
150 1407	62 616	150	3016	1319	COI150N150	336	215	160	120	40	255	105	6	M16	17	130	4xM16 23	M215x4 56	85
		300	6032	2639	COI150N300	486				405	118								
200 1984	76 748	150	4253	1602	COI200N150	355	255	190	150	48	268	135	7	M16	17	140	4xM16 23	M255x4 60	129
		300	8506	3204	COI200N300	505				418	177								
300 2908	94 923	150	6232	1979	COI300N150	391	305	230	190	60	290	175	7	M16	17	200	4xM16 30	M305x4 74	208
		300	12464	3958	COI300N300	541				440	278								
400 4008	112 1099	150	8588	2356	COI400N150	421	355	270	230	70	310	215	7	M16	17	250	4xM20 33	M355x4 84	307
		250	14314	3927	COI400N250	521				410	373								
500 4948	154 1512	150	10603	3240	COI500N150	462	395	300	250	80	330	235	12	M16	17	280	4xM20 40	M395x4 100	416
		250	17671	5400	COI500N250	562				430	495								

\* Nominal value; see kN for the exact force

### ACCESSORIES: ZTT TILT SADDLES

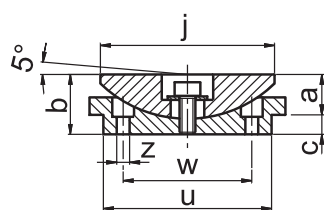

MODEL	For use with	a	b	c	j	u	z	w	kg
ZTT11	COI10N ###	9	21	12	34	M24x2	-	-	0,1
ZTT31	COI30N ###	16	30	14	53	M32x2	-	-	0,3
ZTT51	COI50N ###	18	26	8	68	65	5,5	45	0,8
ZTT101	COI100N ###	22	32	10	88	85	6,5	65	1,6
ZTT151	COI150N ###	32	42		118	105		80	3,2
ZTT201	COI200N ###	39	51	12	148	135	8,5	110	6,5
ZTT301	COI300N ###	43	55		158	175		150	11,0
ZTT401	COI400N ###	56	68		196	215		190	20,2
ZTT501	COI500N ###	56	68		235			210	23,2